

AREA STATEMENT		VERSION NO. 1.101.06	
PROJECT DETAIL		VERSION DATE: 08/08/2018	
Region	ANANTAPUR REGION	Plot Use	Residential
Authority	ANANTAPUR URBAN DEVELOPMENT AUTHORITY	Plot Sub Use	Bungalow/Dwelling/Non Apartment
RA No.	107/2002/PRPHTHADUKUT/2018/Mortgage	Land Use Zone	Residential use Zone
Application Type	General/Proposal	Main Abutting Road Width	30
Project Type	Open Layout	Survey No.	41/8, 41/9
Nature of Development	New	North	-
Soil Location	NA	South	-
Tolerance Zone	Within 500 mtrs of Village Habitation	East	-
Village Name	Gangulakunta	West	-
AREA DETAILS			
AREA OF PLOT (Minimum)	(A)		50 MT
Deduction for Net Plot Area			1274.61
Road Widening Area			336.23
Total			336.23
NET AREA OF PLOT	(A-Deductions)		15408.38
Deduction for Balance Plot Area			336.23
Amenity Area			229.93
Total			665.93
BALANCE AREA OF PLOT	(A-Deductions)		15078.68

TTP Info		
TTP NAME AND SIGNATURE	STRUCTURAL ENG NAME AND SIGNATURE	BUILDER NAME AND SIGNATURE
Kundan Vennart COAHUDAENGATP.A		

Color Notes	
COLOR INDEX	
Plot / Site lines	Green
Existing street / road	Red
Proposed work including services	Blue
Existing construction proposed to be demolished	Yellow
Existing structure to be retained	Grey
Work in progress duly sanctioned	Orange
Open Space	Light Green
Drainage and Sewerage work	Light Blue
Water Supply work	Light Purple
Deductions	Light Yellow
Recreation ground	Light Green

Individual Plot Area									
Plot No.	Abutting Road	Plot Area	Plot Width	Plot Depth	Frontage	Plot Area	Plot Width	Plot Depth	Frontage
1	100.00	237.17	8.00	13.84	-	19.95	-	0.00	-
2	100.00	190.10	8.00	8.00	-	20.00	-	0.00	-
3	100.00	201.82	8.00	10.00	-	20.00	-	0.00	-
4	100.00	202.89	8.00	20.00	-	20.29	-	0.00	-
5	100.00	203.96	8.00	10.00	-	20.34	-	0.00	-
6	100.00	203.82	8.00	10.00	-	20.38	-	0.00	-
7	100.00	204.89	8.00	10.00	-	20.45	-	0.00	-
8	100.00	205.96	8.00	10.00	-	20.52	-	0.00	-
9	100.00	206.18	8.00	10.00	-	20.62	-	0.00	-
10	100.00	206.85	8.00	10.00	-	20.69	-	0.00	-
11	100.00	207.92	8.00	10.00	-	20.75	-	0.00	-
12	100.00	208.20	8.00	10.00	-	20.82	-	0.00	-
13	100.00	208.87	8.00	10.00	-	20.89	-	0.00	-
14	12.00 M WIDE INTERNALROAD Internal Road	100.00	222.22	8.00	14.70	-	10.88	-	14.70
15	12.00 M WIDE INTERNALROAD Internal Road	100.00	122.98	8.00	12.01	-	10.26	-	21.98
16	12.00 M WIDE INTERNALROAD Internal Road	100.00	120.00	8.00	10.00	-	12.00	-	10.00
17	12.00 M WIDE INTERNALROAD Internal Road	100.00	120.00	8.00	10.00	-	12.00	-	10.00
18	12.00 M WIDE INTERNALROAD Internal Road	100.00	120.00	8.00	10.00	-	12.00	-	10.00
19	12.00 M WIDE INTERNALROAD Internal Road	100.00	120.00	8.00	10.00	-	12.00	-	10.00
20	12.00 M WIDE INTERNALROAD Internal Road	100.00	120.00	8.00	10.00	-	12.00	-	10.00
21	12.00 M WIDE INTERNALROAD Internal Road	100.00	120.00	8.00	10.00	-	12.00	-	10.00
22	12.00 M WIDE INTERNALROAD Internal Road	100.00	120.00	8.00	10.00	-	12.00	-	10.00
23	12.00 M WIDE INTERNALROAD Internal Road	100.00	120.00	8.00	10.00	-	12.00	-	10.00
24	12.00 M WIDE INTERNALROAD Internal Road	100.00	120.00	8.00	10.00	-	12.00	-	10.00
25	12.00 M WIDE INTERNALROAD Internal Road	100.00	120.00	8.00	10.00	-	12.00	-	10.00
26	12.00 M WIDE INTERNALROAD Internal Road	100.00	120.00	8.00	10.00	-	12.00	-	10.00
27	12.00 M WIDE INTERNALROAD Internal Road	100.00	177.02	8.00	9.23	-	12.00	-	9.23
28	12.00 M WIDE INTERNALROAD Internal Road	100.00	100.80	8.00	8.40	-	12.00	-	8.40
29	12.00 M WIDE INTERNALROAD Internal Road	100.00	120.00	8.00	10.00	-	12.00	-	10.00
30	12.00 M WIDE INTERNALROAD Internal Road	100.00	120.00	8.00	10.00	-	12.00	-	10.00
31	12.00 M WIDE INTERNALROAD Internal Road	100.00	120.00	8.00	10.00	-	12.00	-	10.00
32	12.00 M WIDE INTERNALROAD Internal Road	100.00	120.00	8.00	10.00	-	12.00	-	10.00
33	12.00 M WIDE INTERNALROAD Internal Road	100.00	120.00	8.00	10.00	-	12.00	-	10.00
34	12.00 M WIDE INTERNALROAD Internal Road	100.00	120.00	8.00	10.00	-	12.00	-	10.00
35	12.00 M WIDE INTERNALROAD Internal Road	100.00	120.00	8.00	10.00	-	12.00	-	10.00
36	12.00 M WIDE INTERNALROAD Internal Road	100.00	120.00	8.00	10.00	-	12.00	-	10.00
37	12.00 M WIDE INTERNALROAD Internal Road	100.00	120.00	8.00	10.00	-	12.00	-	10.00
38	12.00 M WIDE INTERNALROAD Internal Road	100.00	127.93	8.00	9.13	-	10.78	-	9.13
39	12.00 M WIDE INTERNALROAD Internal Road	100.00	123.36	8.00	12.01	-	10.29	-	22.01
40	12.00 M WIDE INTERNALROAD Internal Road	100.00	120.00	8.00	10.00	-	12.00	-	10.00
41	12.00 M WIDE INTERNALROAD Internal Road	100.00	120.00	8.00	10.00	-	12.00	-	10.00
42	12.00 M WIDE INTERNALROAD Internal Road	100.00	120.00	8.00	10.00	-	12.00	-	10.00
43	12.00 M WIDE INTERNALROAD Internal Road	100.00	120.00	8.00	10.00	-	12.00	-	10.00
44	12.00 M WIDE INTERNALROAD Internal Road	100.00	120.00	8.00	10.00	-	12.00	-	10.00
45	12.00 M WIDE INTERNALROAD Internal Road	100.00	120.00	8.00	10.00	-	12.00	-	10.00
46	12.00 M WIDE INTERNALROAD Internal Road	100.00	120.00	8.00	10.00	-	12.00	-	10.00
47	12.00 M WIDE INTERNALROAD Internal Road	100.00	120.00	8.00	10.00	-	12.00	-	10.00
48	12.00 M WIDE INTERNALROAD Internal Road	100.00	120.00	8.00	10.00	-	12.00	-	10.00
49	12.00 M WIDE INTERNALROAD Internal Road	100.00	100.80	8.00	8.40	-	12.00	-	8.40
50	12.00 M WIDE INTERNALROAD Internal Road	100.00	202.65	8.00	17.24	-	10.23	-	17.24
51	12.00 M WIDE INTERNALROAD Internal Road	100.00	200.00	8.00	10.00	-	20.00	-	10.00
52	12.00 M WIDE INTERNALROAD Internal Road	100.00	199.96	8.00	10.00	-	20.00	-	10.00
53	12.00 M WIDE INTERNALROAD Internal Road	100.00	200.57	8.00	10.64	-	20.00	-	13.73
54	12.00 M WIDE INTERNALROAD Internal Road	100.00	248.90	8.00	15.61	-	20.07	-	7.22
55	12.00 M WIDE INTERNALROAD Internal Road	100.00	383.12	8.00	18.57	-	20.15	-	18.57

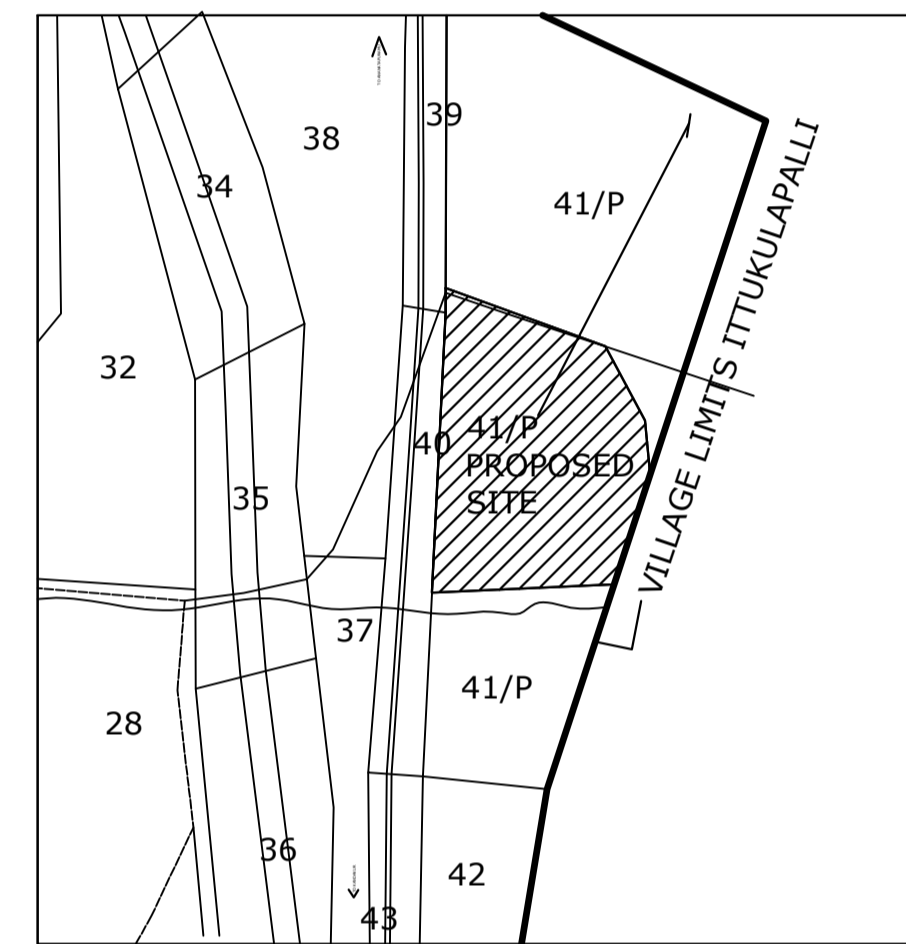
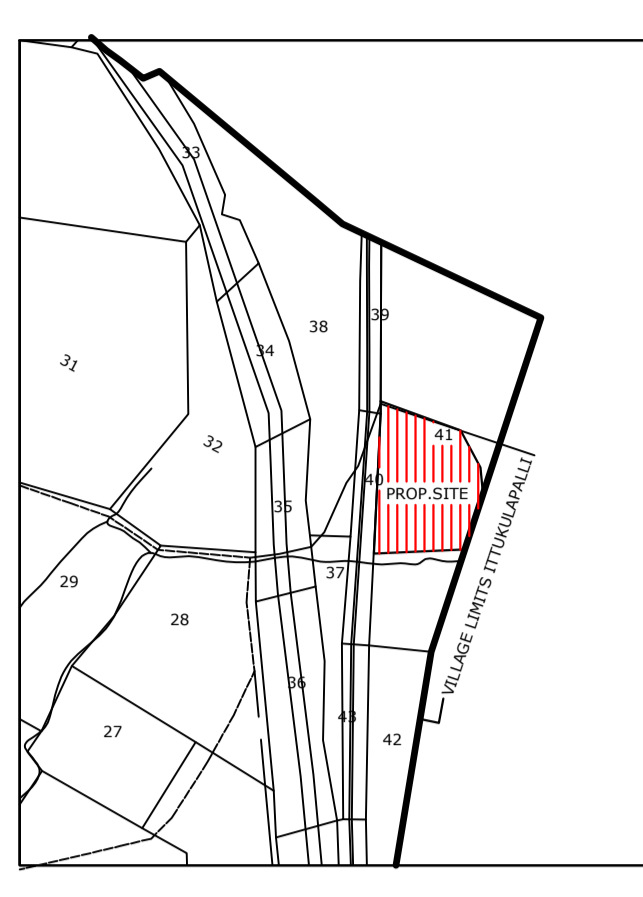
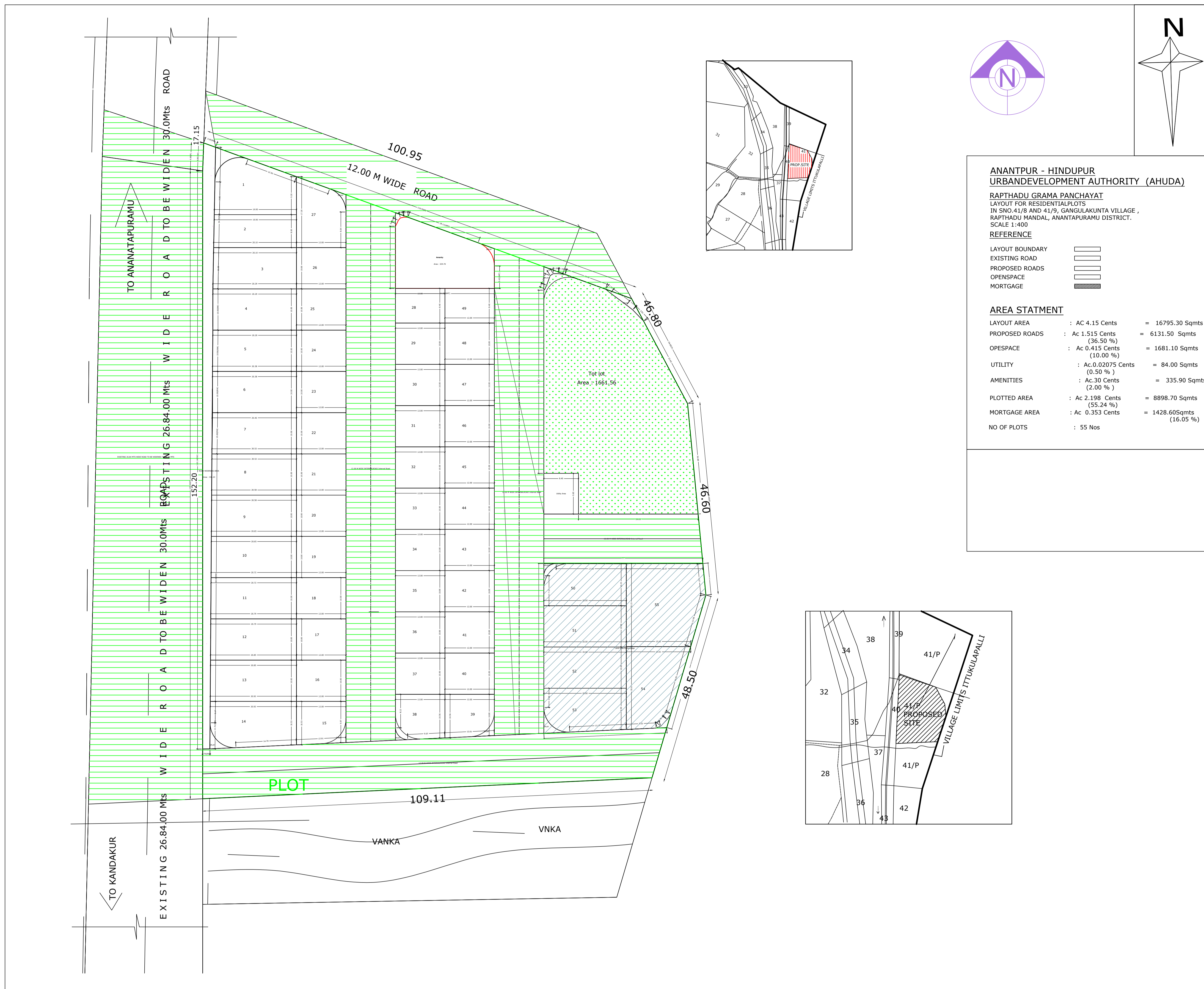

**ANANTPUR - HINDUPUR URBANDEVELOPMENT AUTHORITY (AHUDA)**  
**RAPHTHADU GRAMA PANCHAYAT**  
 LAYOUT FOR RESIDENTIAL PLOTS IN SNO.41/8 AND 41/9, GANGULAKUNTA VILLAGE, RAPHTHADU MANDAL, ANANTAPURAMU DISTRICT, SCALE: 1:400

**REFERENCE**  
 LAYOUT BOUNDARY  
 EXISTING ROAD  
 PROPOSED ROADS  
 OPENS/SPACE  
 MORTGAGE

**AREA STATEMENT**  
 LAYOUT AREA : AC 4.15 Cents = 16795.30 Sqmts  
 PROPOSED ROADS : AC 1.515 Cents (36.50 %) = 6131.50 Sqmts  
 OPENS/SPACE : AC 0.415 Cents (10.00 %) = 1681.10 Sqmts  
 UTILITY : AC 0.02075 Cents (0.50 %) = 84.00 Sqmts  
 AMENITIES : AC 0.30 Cents (7.00 %) = 335.90 Sqmts  
 PLOTTED AREA : AC 2.198 Cents (55.24 %) = 8898.70 Sqmts  
 MORTGAGE AREA : AC 0.353 Cents (8.65 %) = 1428.60 Sqmts (16.05 %)  
 NO OF PLOTS : 55 Nos

# SITE PLAN

Land Area to Mortgage Details		
Name	Ind Plot Name	Area
	50	202.65
	52	199.96
	53	200.57
	54	248.90
	55	383.12
<b>Total</b>		<b>1215.20</b>

Land use analysis/Area distribution (Table 2c)			
Area covered under	Proposed Area in sq. mt	Proposed Area in sq. ft	Percentage(%)
Plotted Area	8977.65	10198.98	54.16
Road Area	5121.51	6125.29	32.53
Amenity	329.70	384.31	2.02
Public Open Space	1681.56	1887.21	10.55
Utility Area	84.70	98.81	0.53
<b>Total net layout</b>		<b>18804.71</b>	<b>99.86</b>